

CARRIAGE REPLACEMENT PROCEDURE

DESK TRIM PLUS

Warning

- Carefully read the instructions before and during the assembly phases.
- Tighten all the screws to prevent the machine from collapsing, thus avoiding damages to the product or people.

Replacing procedure

COMPLETE CARRIAGE

Follow this procedure to replace the entire carriage:

- Remove the two screws that fix the shoulder (only on one side) **A**.
- Slide out the ruined carriage and insert the new one **B**.
- Tighten the two screws that fix the shoulder which were removed previously **A**.



NEOLT S.p.A.

Via G. Galilei, 8 - 24036 Ponte San Pietro (BG) (Italy)
Tel. (+39) 035.468.811 - fax. (+39) 035 468 886
mail to: mkt@neolt.it - <http://www.neolt.it>

ROTATING BLADE

Follow this procedure to replace the rotating blade:

- Remove the two screws that fix the shoulder (only on one side) **D**.
- Slide out the carriage and tilt it over **E-F**.
- Remove the nuts and the notched washers that fix the plate that locks the carriage guide bushes. **G**.
- Remove the two benzing rings that block the blade holder shaft to the carriage **H-I**.
- Slide out the ruined blade and position the new one **L**.
- Reassemble everything following the procedure in the reverse order.

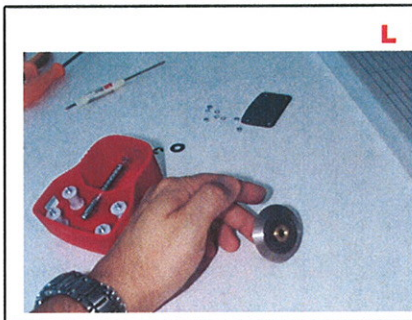
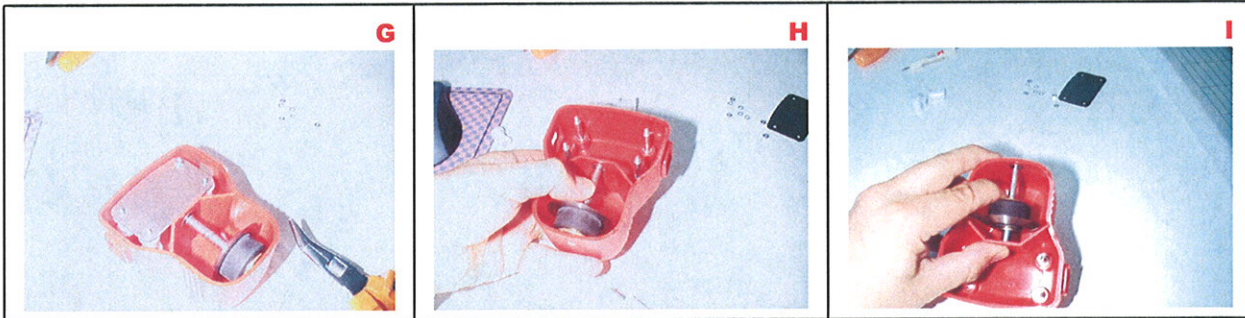
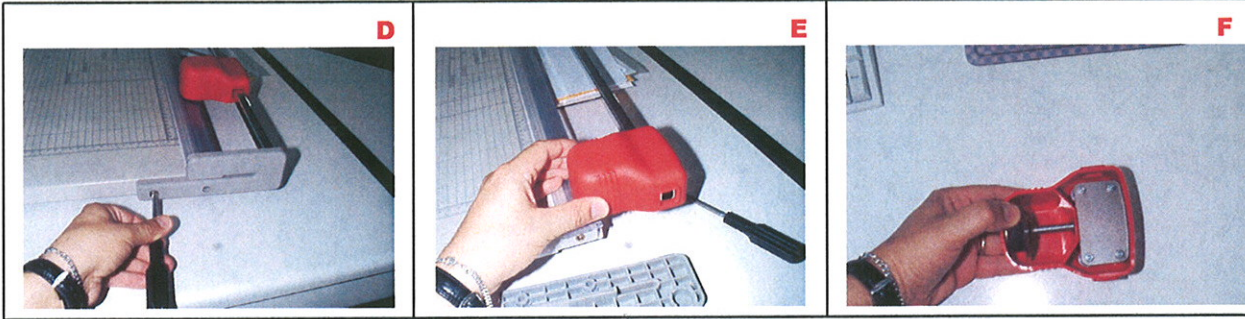

NEOLT S.p.A.

Via G. Galilei, 8 - 24036 Ponte San Pietro (BG) (Italy)
Tel. (+39) 035.468.811 - fax. (+39) 035 468 886
mail to: mkt@neolt.it - <http://www.neolt.it>